

PRELIMINARY GROUND-WATER SURVEY, OTTOSDAL

by

B. Abtmaier

Introduction

This Survey was carried out on behalf of the Department of Water Affairs (see letter 13/11536 of 11th Gebruary 1970) to investigate the groundwater position in a 24 km radius round Ottosdal.

Previous work for the Municipality of Ottosdal was carried out by Mr. S.B. de Villiers (1955) who selected one bore-hole site (G. 10446) and by J.F. Gordon-Welsch (1959) who selected bore-hole sites for the S.A.R. at Ottosdal. Mr. C.J.H. Erasmus selected (1966) 2 bore-hole sites (G. 20591 and G. 20592).

Town watersupply

From the map inset GHP 2761 it can be seen, that at the present moment only 2 bore-holes are pumped for the town supply. Bore-hole B50 which previously yielded 3000 g.p.h. now only yields about 1200 g.p.h., and bore-hole B4 which previously yielded 3800 g.p.h. now yields only 1500 g.p.h. A new bore-hole which was recently drilled north of the town yields about 3000 g.p.h. Bore-hole G. 20591 drilled during February 1966 was selected by Mr. Erasmus and yields 2800 g.p.h. This bore-hole is used only for the water supply of the location.

Seeing that the yields of the bore-holes decreased with the time we can also expect that the yield of the newly drilled bore-hole of 3000 g.p.h. will become less. Another interesting fact is, that the waterlevel of the bore-hole near the spring dropped during the period 1956 to 1970 from 5 ft. to 52 ft. (See plotted data of waterlevels and pumping figures). According to White Paper W.P.W.-'66 the water consumption of Ottosdal for 1970 should be 87,000 g.p.d. and in 1988 it could be 101,000 g.p.d.

The yield of the three bore-holes in use at present is 5700 g.p.h. If pumped only 10 hours a day it will ammount to 57,000 g.p.d. which is not sufficient for the town supply.

Pumping the bore-holes longer than 10 hours a day can weaken the existing supplies.

Physiography and Geology

The area forms part of the Highveld of the southwestern Transvaal with an altitude between 1370 meters and 1520 meters above mean sea level. The average annual rainfall amounts to approximately 550 mm.

From the map GHP 2761 it can be seen, that the area north of the town is drained to the north and the southern area to the south.

The Archaean Granite which is usually a medium to coarse-grained rock, outcrops to the west and north of Ottosdal. Outcrops of the Dominion Reef System with conglomerates, schists, amygdaloidal and porphyritic lava, shaly tuffaceous rocks and sericitic quartzite (at the present moment prospected for uranium) are present in the immediate vicinity of Ottosdal.

The Witwatersrand System has patchy outcrops to the south and to the southeast of Ottosdal, consisting mainly of shales and quartzites.

The Ventersdorp System with andesitic amygdaloidal lava and quartz porphyry and volcanic conglomerate occupies the greatest part of the surveyed area.

Tertiary to Recent deposits (gravel, surface limestone, silcrete) are present to the west and south of the town.

Bore-holes with high yields

Looking at GHP 2761 and the tabulated bore-hole information the following areas with strong bore-hole supplies can be identified.

- (a) on the Ottosdal Townlands a bore-hole with a yield of approximately 3000 g.p.h. was drilled in the shales some weeks ago. This bore-hole is situated in a laagte to the north of the town. Approximately 100 meters further north two other bore-holes in the same laagte yield 2000 g.p.h. According to a report by S.B. de Villiers (1951), bore-holes in these shales normally yield a fair amount of water if drilled deep enough.

It may therefore be advisable to start a survey for additional boring sites on Municipality property along this laagte.

- (b) Along a laagte, starting approximately 8 kilometers west of the town and draining to the west, some strong bore-holes exist on the farms Doornkuil, Kareekuil and Boschpan. Bore-hole 2, 4, 16 yield approximately 20,000 g.p.h. each and number 91 approximately 12,000 g.p.h. Bore-holes 2 and 4 are approximately 22 Kilometers west of the town. No information regarding the formation in which these two bore-holes were drilled could be obtained, except that the first 40 feet were drilled in alluvial gravel. Bore-hole 16 was drilled down to 154 feet in pegmatitic granite and from 154 to 162 feet in biotite granite. The strong water was struck at the contact of these two granites. This observation was also made at some strong bore-holes in granite in the vicinity of Delareyville.
- (c) Another line of strong bore-holes occur along a north-draining laagte approximately 13 kilometers north-east of Ottosdal, on the farms Holfontein, Rhenosterput and Goedgedacht. All these bore-holes seem to be drilled in Archaean granite. To the west of this laagte displaced outcrops of sercitic quartzite of the Dominion Reef System striking NW-SE and dipping west, forms the contact between the lava of the Dominion Reef System and the Archaean granite. A fair amount of water may be struck on the contact of the quartzite and the adjacent rocks, or in the fault zones along which the quartzite bands were displaced.
- (d) Two other strong bore-holes of approximately 20,000 g.p.h. each occur on farm Doornlaagte approximately 22 kilometers north of Ottosdal, and on farm Kliprif approximately 16 kilometers south of the town.
- (e) Approximately 19 kilometers east of Ottosdal some bore-holes, probably drilled in Ventersdorp lava and yielding between 3000 and 6000 g.p.h., are situated along a south-draining laagte. On a tributary of this laagte a bore-hole on farm Vlakfontein yields approximately 18,000 g.p.h.

- (f) On the farm Kareekuul about 6 kilometers south of Ottosdal a bore-hole in the lava of Dominion Reef System yields approximately 7000 g.p.h. The chances for developing further strong bore-hole supplies on this farm seem promising. The average depth of the bore-holes in granite is 120 feet; the water is usually struck between 50 and 110 feet. The average depth of the bore-holes drilled in lava is also 120 feet, and water is struck between 50 and 90 feet.

Conclusions and recommendations

1. There are 6 different areas within a radius of 22 kilometers round Ottosdal where bore-holes with yields varying between 6000 and 20,000 g.p.h. exist.
2. Further detailed investigations for additional ground-water supplies should first concentrate on the laagte to the north of the town where a bore-hole yielding 3000 g.p.h. has been completed recently.
3. In the investigated area only 60 morgen, mostly with lucerne, are being irrigated with bore-hole water. It should therefore be relatively easy to obtain ground-water from farmers with strong bore-holes.
4. It must be considered that Ottosdal is situated on a watershed, and thus the recharge by rainfall infiltration will not replenish the aquifer round the town. The infiltrated water will recharge the aquifers to the north and the south of the town following the surface drainage lines.
5. Information obtained from farmers shows, that the yields of bore-holes diminished approximately 50 per cent during the last 5 years. For this reason pumping tests should be carried out to obtain more information regarding the hydraulic properties of the aquifers.

GEOLOGIESE OPNAME

GEOFISIESE GEGEWENS BY BOORPLEKKE

Eienaar Munisipaliteit

Datum aangewys. 14/6/1955

Plaas Ottosdal

Datum geboor

Distrik Lichtenburg

G.-No.

10446

Boorgat-No

ELEKTRIESE DIEPTEMETING

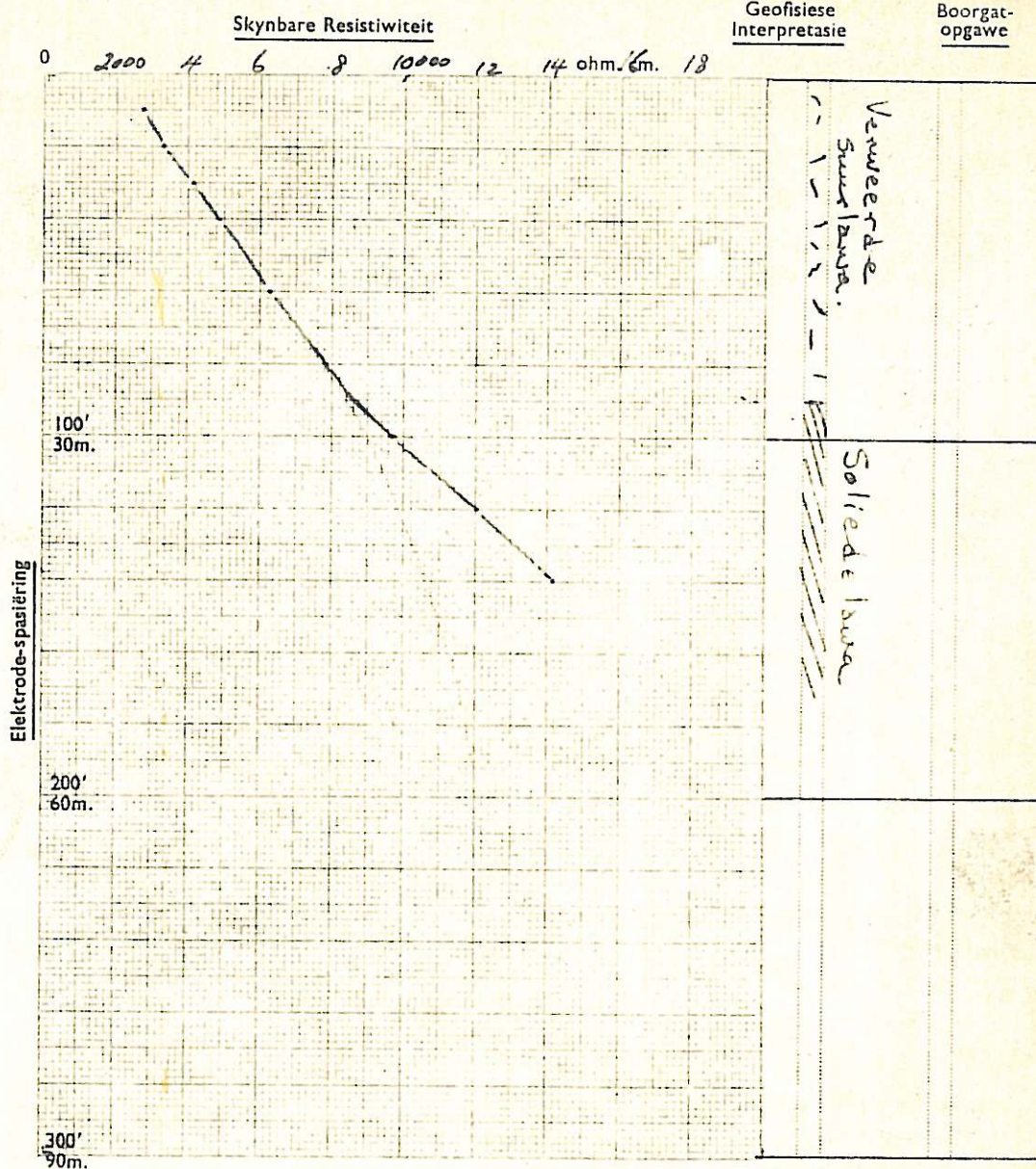

Diepte Aanbeveel :— 150'

Water

Getref op Vt.
 Rushoogte Vt.
 Sterkte g.p.u.
 Resistiwiteit (p) ohm. cm.

Geofisiese Waarnemings

Aantal Elektriese Dieptemetinge 40
 Afstand op konstante diepte gemeet
 Aantal Magn. waarnemings 37
 Lengte Mag. W—lyne 680 lye

WEERSTANDSLESINGS

Resistiwiteit (ohm. cm.)	Potensiaal (volts)	Stroom (amps)	Spanning van Battery	Elektrode-spasiëring (a)
2735	.0145	.01	90	3
3265	.00865			6
4130	.00730			9
4830	.00640			12
6240	.00556			18
7840	.00520			24
9750	.00517			30
12000	.00530			36
14140	.00535			42

Magnetiese Kurwe en Geologiese Profiel

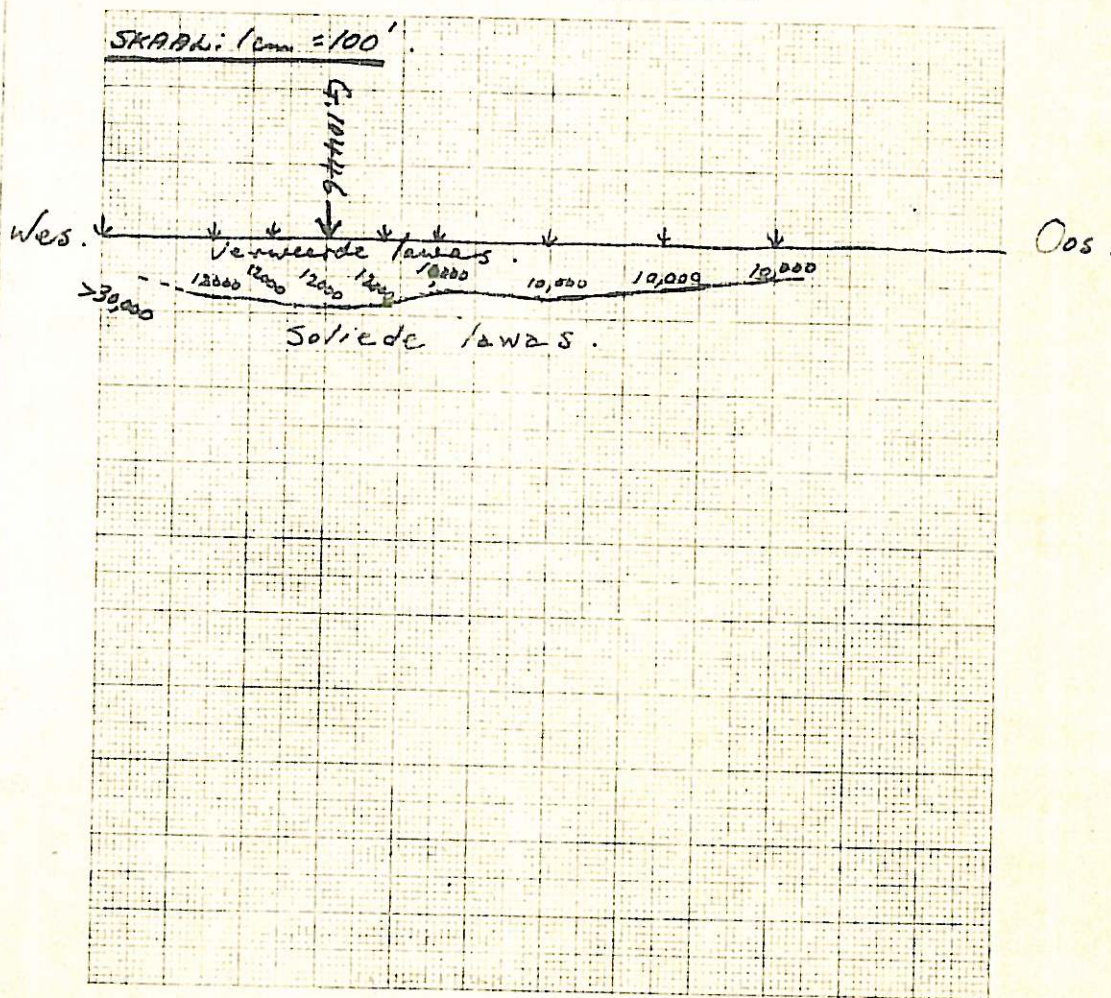

GEOLOGIESE OPNAME
GEOFISIESE GEGEWENS BY BOORPLEKKE

G.—No.

4252.

Eienaar: PAT.
 Plaas: Ottosdal Padkamp
 Distrik: Lichtenburg

Datum aangewys: 25/8/49.
 Datum geboor:

Boorgat—No.

ELEKTRIESE DIEPTEMETING

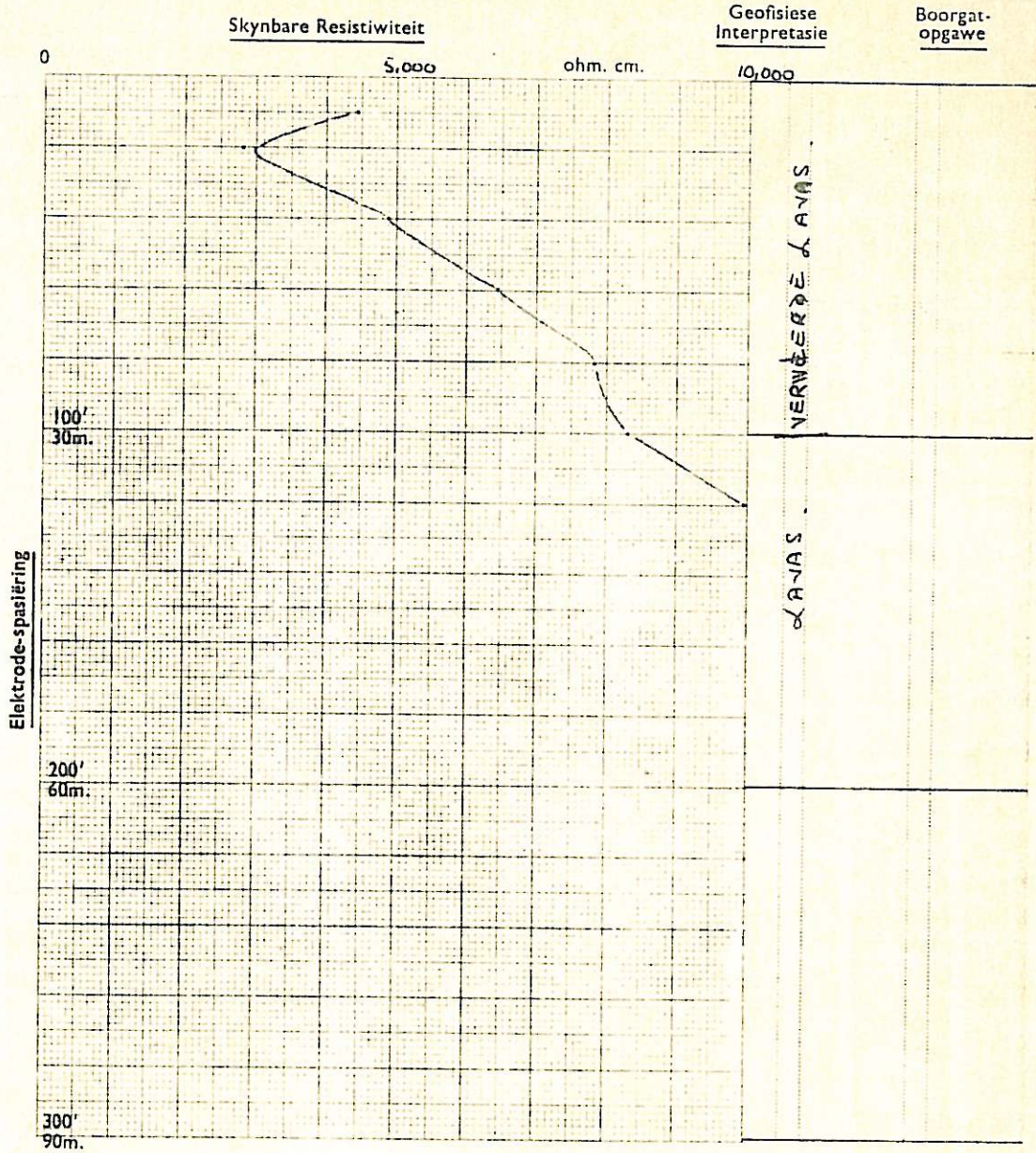

Diepte Aanbeveel :— 105 .

Water

Getref op.....Vt.
 Rushoogte.....Vt.
 Sterkte.....g.p.u.
 Resistiwiteit (ρ).....ohm. cm.

Geofisiese Waarnemings

Aantal Elektriese Dieptemetinge 10 .
 Afstand op konstante diepte gemeet

Aantal Magn. waarnemings

Lengte Mag. W—lyne

WEERSTANDSLESINGS

Elektrode-spasiëring (a)	Spanning van Battery	Stroom (amps)	Potensiaal (volts)	Resistiwiteit (ohm. cm.)
3	180V	.01	.0235	4,450
60075	2,830
120065	4,900
180057	6,450
240052	7,850
300044	8,300
360041	9,950

Magnetiese Kurwe en Geologiese Profiel

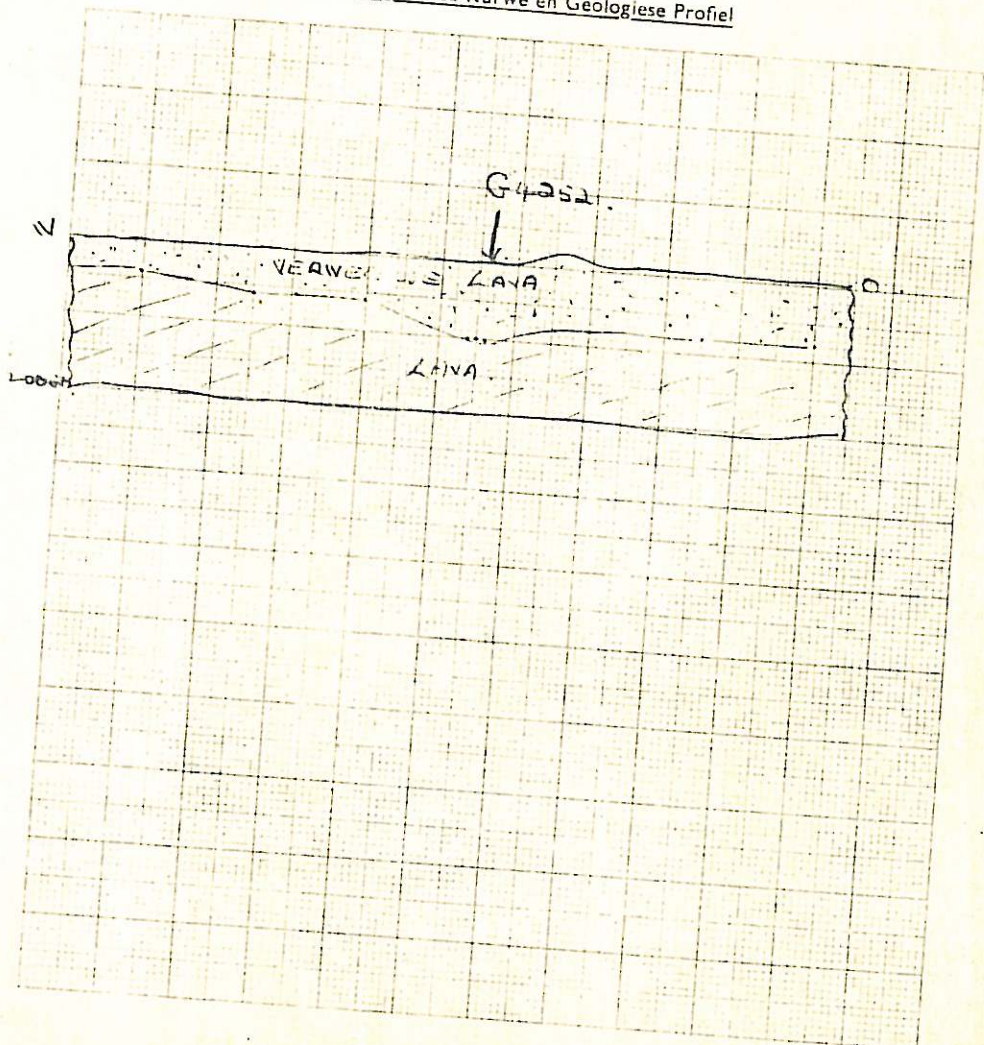

G.P.-S.

M.D. 1031.

GEOLOGIESE OPNAME

GEOFISIESE GEGEWENS BY BOORPLEKKE

G.—No.

Eienaar OTTOSDAL MUN.

Datum aangewys 3/2/66

20592

Plaas

Datum geboor

Boorgat—No.

Distrik OTTOSDAL

ELEKTRIESE DIEPTEMETING

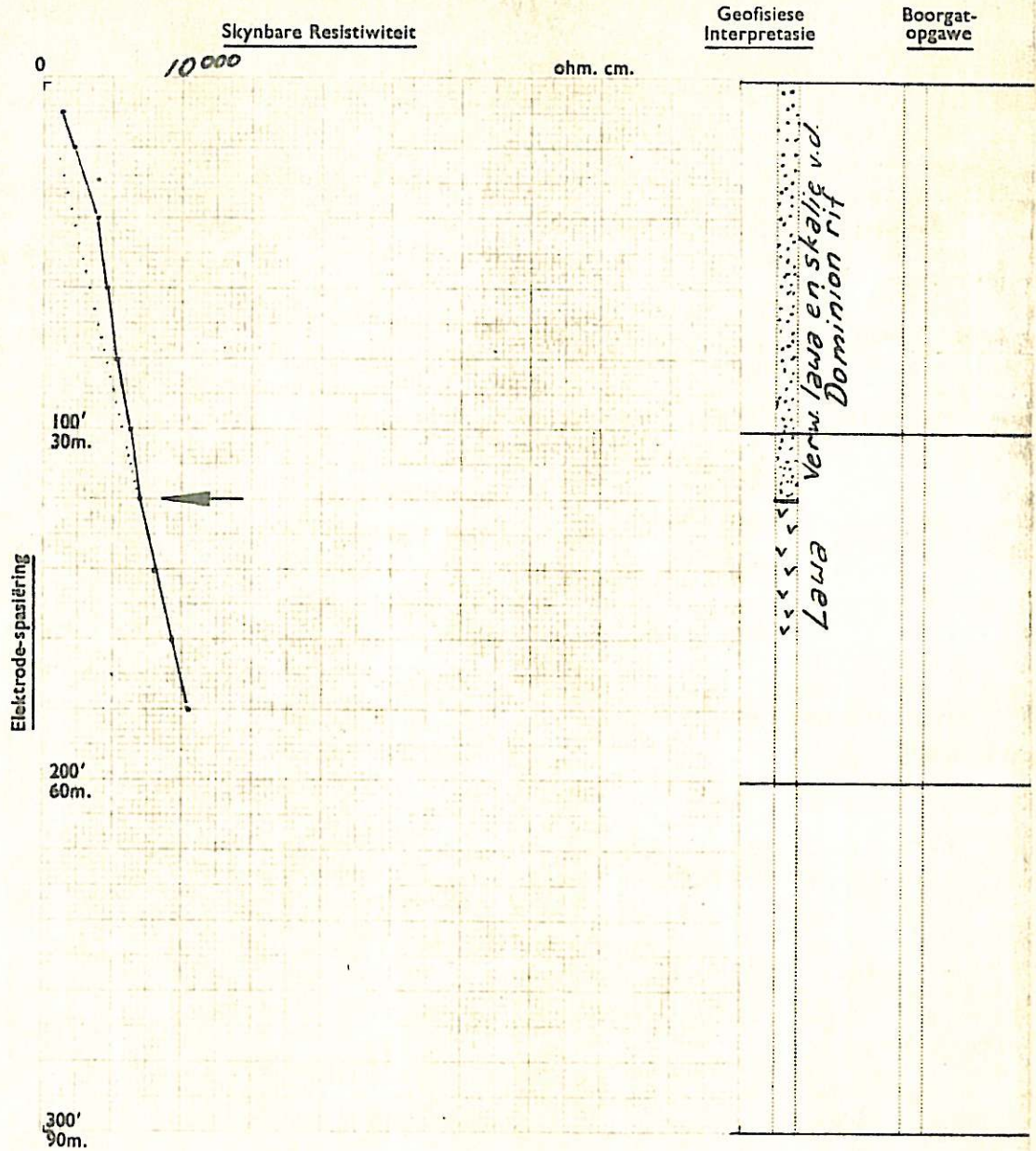

Diepte Aanbeveel :— 160'

Water

Geofisiese Waarnemings

Getref op Vt.

Aantal Elektriese Dieptemetinge 74

Rushoogte Vt.

Afstand op konstante diepte gemeet

Sterkte g.p.u.

Aantal Magn. waarnemings

Resistiwiteit (ρ) 7,500 ohm. cm.

Lengte Mag. W —lyne

GEOLOGIESE OPNAME

GEOFISIESE GEGEWENS BY BOORPLEKKE

G.—No.

Eienaar OTTOSDAL MUNICIPAL.

Datum aangewys 2/2/66

2059/

Plaas

Datum geboor

Boorgat—No.

Distrik OTTOSDAL

ELEKTRIESE DIEPTEMETING

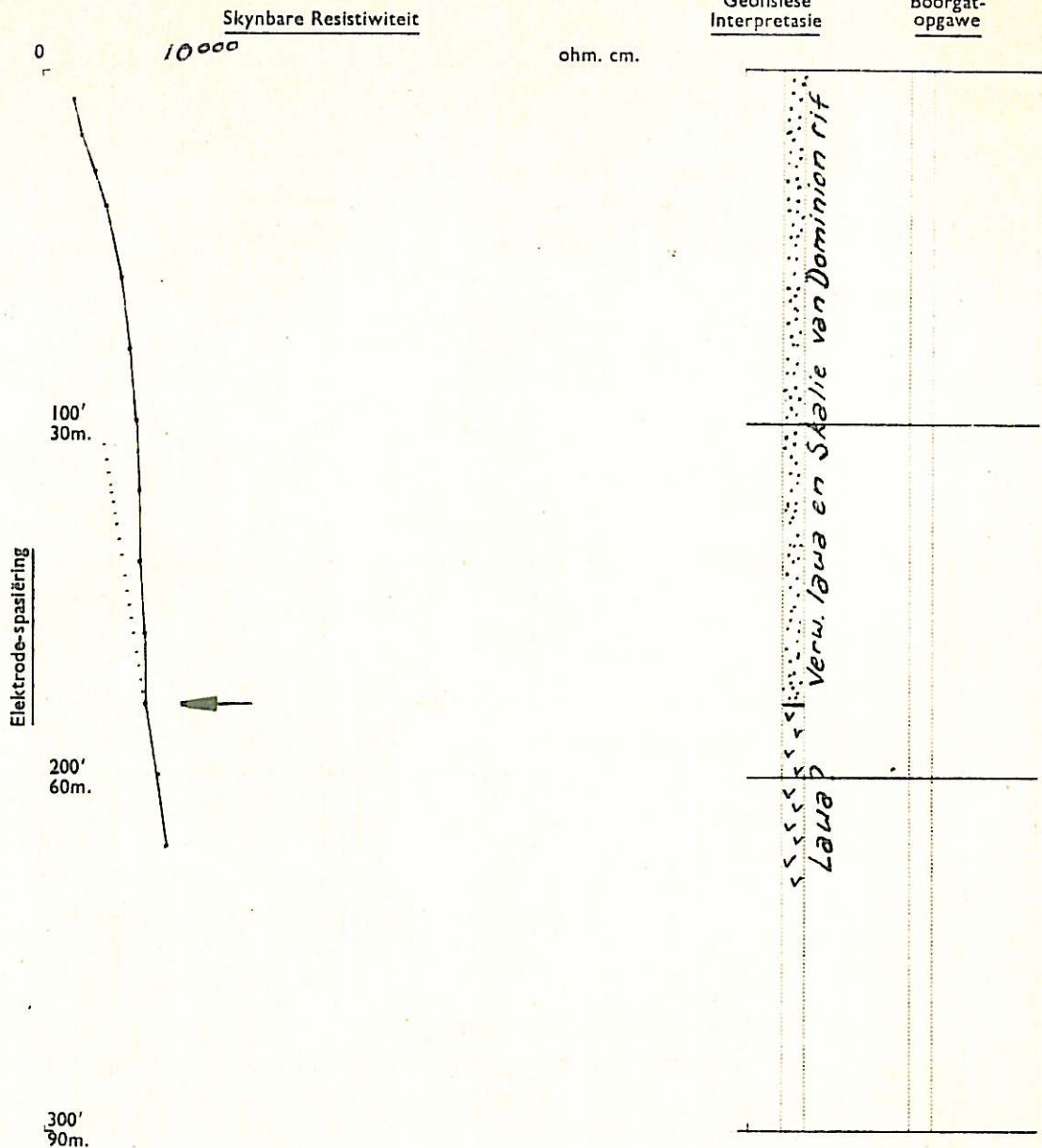

Diepte Aanbeveel :— 250'

Water

Geofisiese Waarnemings

Getref op.....Vt.

Aantal Elektriese Dieptemetinge..... 7A

Rushoogte.....Vt.

Afstand op konstante diepte gemeet.....

Sterkte.....g.p.u.

Aantal Magn. waarnemings.....

Resistiwiteit (ρ) 7,500 ohm. cm.

Lengte Mag. W —lyne.....

1902-63-100-50

Province

TRANSVAAL

Plans

Farm OTTOSDAL DORP

Nr. No.

Distrik District

OTTOSDAL

Eienaar Owner

OTTOSDAL

Topo-Kadas. Verw.

Topo-Cadas. Ref.

1/4170

1/4170

1/4170

1/4170

1/4170

1/4170

1/4170

1/4170

1/4170

1/4170

1/4170

1/4170

1/4170

1/4170

1/4170

1/4170

1/4170

1/4170

1/4170

1/4170

1/4170

1/4170

1/4170

1/4170

1/4170

1/4170

1/4170

1/4170

1/4170

1/4170

1/4170

1/4170

1/4170

1/4170

1/4170

1/4170

1/4170

1/4170

1/4170

1/4170

1/4170

1/4170

1/4170

1/4170

1/4170

1/4170

1/4170

1/4170

1/4170

1/4170

1/4170

1/4170

1/4170

1/4170

1/4170

1/4170

1/4170

1/4170

1/4170

1/4170

1/4170

1/4170

1/4170

1/4170

1/4170

1/4170

1/4170

1/4170

1/4170

1/4170

1/4170

1/4170

1/4170

1/4170

1/4170

1/4170

1/4170

1/4170

1/4170

1/4170

1/4170

1/4170

1/4170

1/4170

1/4170

1/4170

1/4170

1/4170

1/4170

1/4170

1/4170

1/4170

1/4170

1/4170

1/4170

1/4170

1/4170

1/4170

1/4170

1/4170

1/4170

1/4170

1/4170

1/4170

1/4170

1/4170

1/4170

1/4170

1/4170

1/4170

1/4170

1/4170

1/4170

1/4170

1/4170

1/4170

1/4170

1/4170

1/4170

1/4170

1/4170

1/4170

1/4170

1/4170

1/4170

1/4170

1/4170

1/4170

1/4170

1/4170

1/4170

1/4170

1/4170

1/4170

1/4170

1/4170

1/4170

1/4170

1/4170

1/4170

1/4170

1/4170

1/4170

1/4170

1/4170

1/4170

1/4170

1/4170

1/4170

1/4170

1/4170

1/4170

1/4170

1/4170

1/4170

1/4170

1/4170

1/4170

1/4170

1/4170

1/4170

1/4170

1/4170

1/4170

1/4170

1/4170

1/4170

1/4170

1/4170

1/4170

1/4170

1/4170

1/4170

1/4170

1/4170

1/4170

1/4170

1/4170

1/4170

1/4170

1/4170

1/4170

1/4170

1/4170

1/4170

1/4170

1/4170

1/4170

1/4170

1/4170

1/4170

1/4170

1/4170

1/4170

1/4170

1/4170

1/4170

1/4170

1/4170

1/4170

1/4170

1/4170

1/4170

1/4170

1/4170

1/4170

1/4170

1/4170

1/4170

1/4170

1/4170

1/4170

1/4170

1/4170

1/4170

1/4170

1/4170

1/4170

1/4170

1/4170

1/4170

1/4170

1/4170

1/4170

1/4170

1/4170

1/4170

1/4170

1/4170

1/4170

1/4170

1/4170

1/4170

1/4170

1/4170

1/4170

1/4170

1/4170

1/4170

1/4170

1/4170

1/4170

1/4170

1/4170

1/4170

1/4170

1/4170

1/4170

1/4170

1/4170

1/4170

1/4170

1/4170

1/4170

1/4170

1/4170

1/4170

1/4170

1/4170

1/4170

1/4170

1/4170

1/4170

1/4170

1/4170

1/4170

1/4170

1/4170

1/4170

1/4170

1/4170

1/4170

1/4170

1/4170

1/4170

1/4170

1/4170

1/4170

1/4170

1/4170

1/4170

1/4170

1/4170

1/4170

1/4170

1/4170

1/4170

1/4170

1/4170

1/4170

1/4170

1/4170

1/4170

1/4170

1/4170

1/4170

1/4170

1/4170

1/4170

1/4170

1/4170

Distrik: LICHTENBURG.

Nommer:

Plaas: OTTOSDAL PADKAMP

Eienaar: P.A.T

Topo. Kad. Verw. 1943 N. 1240.

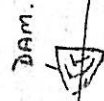

NA LICHTENBURG

BOERPLAAS.

VOORGESTELDE
PADKAMP
TERREIN.

GRENZ VAN OTTOSDAL DORPSGROND.

OTTOSDAL.

GEOLOGIESE OPNAME.
GEOLOGICAL SURVEY.BOORPLEKKE.
BORING SITES.Geofisiese Verwys. No. } X327/36/23.
Geophysical Ref.

Distrik. District.	Naam en Nommer van Plaas. Name and Number of Farm.		Eienaar. Owner.		
Lichtenburg	Ottosdal - doopsgrond.		Gesondheidskomitee.		
G-nommer. G-number.	Metode van aanwysing. Method of Selection.	Formasie. Formation.	Diepte van verwerking of kontak. Depth of Weathering or Contact.	Diepte aanbeveel. Recommended Depth.	Aan wie gewys. To whom shown.
10446	Geofisies	Suur-lavas	90'	150'	Mrs. Ferreira.

OPMERKINGS EN LIGGING VAN BOORPLEKKE.
REMARKS AND POSITION OF SITES.

Boorplek G. 10446 is aangewys ongeveer 500m
suid van die ~~bestaan~~ boorgat by die steppale. n.
Maksimum diepte van 150 m word aanbeveel.

(Sien aparte verslag oor opname van boorgate
by Ottosdal.)

26/8/55
J.R.V.

Boorplekke aangewys op versoek van
Sites selected at request of

Geologiese Opname

S.B. deVilliers
Naam van Beampte./Name of Officer.Datum 14/6/55.
Date

(Verwysing: 11/49/9)

GEOLOGIESE OPNAME.
GEOLOGICAL SURVEY.

Boorplekke.
Boring Sites.

Geofisiese Verwys. No. } 171/8-9.
Geophysical Ref. No. }

Distrik. District.		Naam en Nommer van Plaas. Name and Number of Farm.		Eienaar. Owner.	
Lichtenburg		Ottoodal-skool.		Prov. Administrasie.	
G-nommer. G-number.	Metode van aanwysing. Method of Selection.	Formasie. Formation.	Diepte van verwerking of kontak. Depth of Weathering or Contact.	Diepte aanbeveel. Recommended Depth.	Aan wie gewys. To whom shown.
-	Geofisies	Witwatersrand-skalie	-	-	-

OPMERKINGS EN LIGGING VAN BOORPLEKKE.
REMARKS AND POSITION OF SITES.

Die skoolgronde in Ottoodal bestaan uit skalies van die Witwatersrand-sisteen.

Op die skoolgronde is drie bestaande boorgate, twee hiervan is droog terwyl die derde boorgat wat 140 voet diep is, ten ooreen ongeveer 100 g.p.u. lewer. Hierdie boorgat het vroeër ongeveer 60 g.p.u. gelever maar het later gedeeltelik toegedat.

Op 'n afstand ongeveer 200 tree noord van die skool is twee boorgate in skalies geboor waaraan die skool en skoolkoshuis water kry. Hierdie boorgate lewer onderskeidelik 720 g.p.u. en 1440 g.p.u. Een van hierdie gate is 328 voet diep. Van die boorgate op die privaat erwe kan geen informasie gekry word nie.

Diepte-metings op die skoolgronde tot 360 voet in die skalies, het geen kontak of soliede formasie ondergronds aan nie.

Volgens boorgatverslae blyk dit dat die diep boorgate redelike goeie waters lewer en dat die water vanaf 140 tot 180 voet verkry word.

Dit word dus aanbeveel dat die bogenoemde boorgat

Boorplekke aangewys op versoek van Kantoor van Geologiese Opname 505.
Sites selected at request of

J. B. de Villiers
Naam van Beampte.
Name of Officer.

Datum 24/7/51
Date
forwarded.
17/8/51.

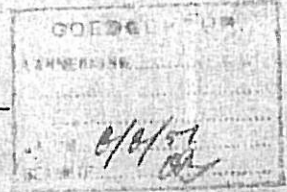

op die skoolgronde met gelyktydig taaiheid het, tot 'n
maksimum diepte van 250 geboor word. of in ander gat kan
naby geboor word.

Plaas: OTTOS DAL Sloot Nummer: Distrik: LICHTENBURG.

Eienaar: Topo. Kad. Verw.

SIEN KARANNA FONT EIN.

Provinsie Wes-Transvaal Plaas: Ottosdal - skool Nummer: - Distrik: Lichtenburg.

Eienaar: Prov. Administrasie Topo. Kad. Verw. 1244-NS-1042 o.w.

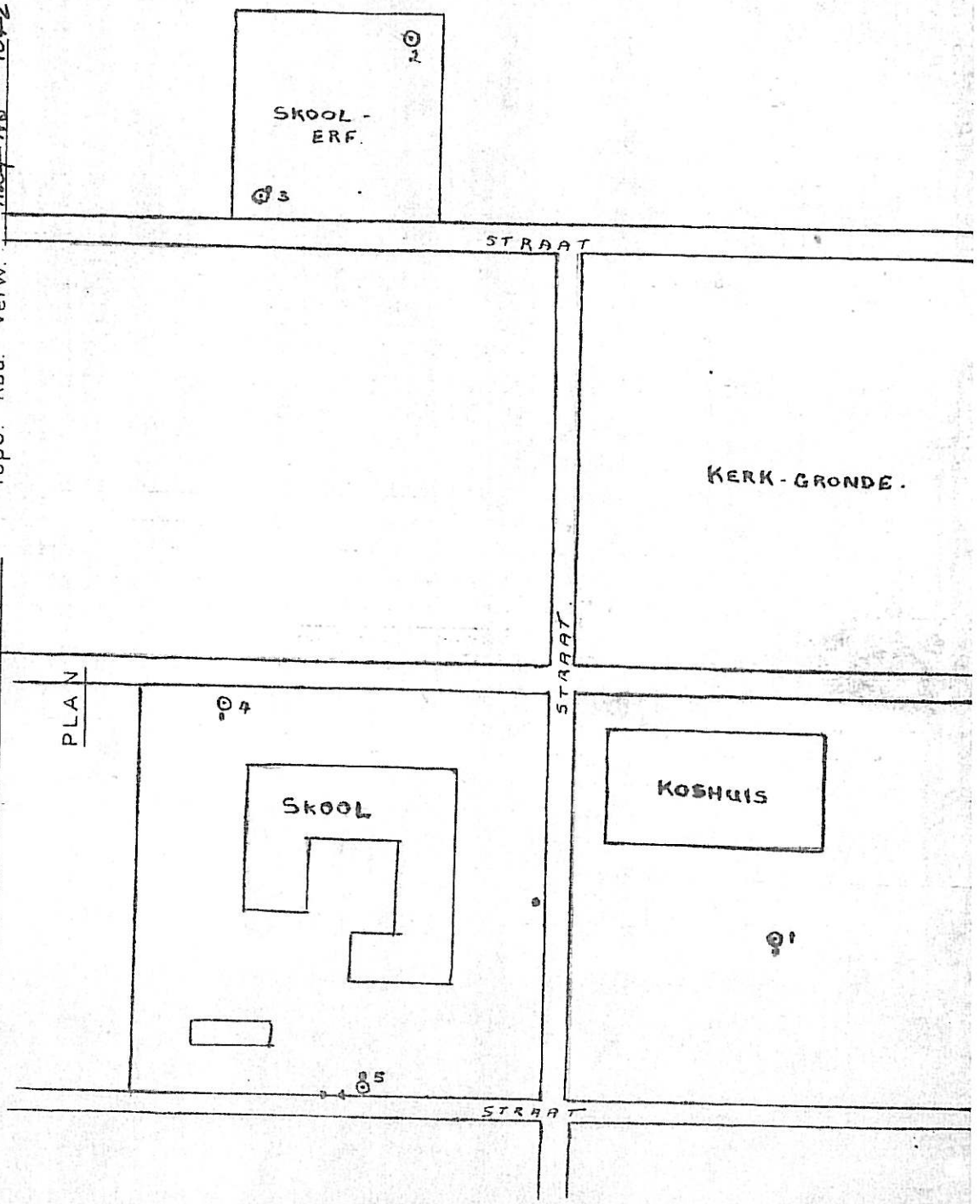

- VERKLARING -

- ⊙ Bestaande boorgate.
- Diepte-melings.
- Witwatersrand-skalië.

SKAAL: 1" = 50 meter.

GEOLOGIESE OPNAME
GEOLOGICAL SURVEY

BOORPLEKKE
BORING SITES

Geofisiese Verwys. No. }
Geophysical Ref. }

Distrik. District.		Naam en Nommer van Plaas. Name and Number of Farm.		Eienaar. Owner.	
Lichtenburg.		Ottoedal Post Office		P. W. D.	
G-nommer. G-number.	Metode van aanwysing. Method of Selection.	Formasie. Formation.	Diepte van verwerking of kontak. Depth of Weathering or Contact.	Diepte aanbeveel. Recommended Depth.	Aan wie gewys. To whom shown.
—	Geological	Dominion Reef series	—	—	—
(No borehole site selected)					

OPMERKINGS EN LIGGING VAN BOORPLEKKE.
REMARKS AND POSITION OF SITES.

~~The grounds on which~~
The ^{terrain} where the Post Office of Ottoedal is situated has been visited on the 31st. August 1956 to select a borehole site for a water supply for the Post Office. ^{at and}

The area in the vicinity of the Post Office is underlain by shales or phyllites of the Dominion Reef series, which was found, by a previous investigation of all the boreholes in the village, to be a very poor water-bearing formation. On the adjoining plot south of the Post Office three boreholes ^{have been} drilled to depths of over 100 to 200 feet in the shales without success. To the north-west of the Post Office the borehole at the Municipal Office is nearly 200 feet ^{deep} and yields about 20 g.p.h. Other dry boreholes ^{were} also drilled to the south-west and north-east of the Post Office. ^{these facts}

In view of ~~these facts~~ a borehole site has not been selected and ^{could not} be recommended in this ^{was not}

Boorplekke aangewys op versoek van
Sites selected at request of

~~Geological Survey (1956-1957) 720~~

Datum
Date 31/8/1956

DATUM 31/8/1956
BEAMPTG. J.B.V.

S.B. de Villiers.
Naam van Beamptg./Name of Officer
*: Water Affairs 8191/478 of J.B.56
P.W. D. (2.705) of 4.7.56
AFGESTELD 08-08
27 OCT 1956

vicinity. It is, however, recommended that the
Post Office should ~~get~~ ^{obtain} ~~their~~ ^{its} water supply from the
municipal water scheme which will be taking
~~effect in the near future~~. Come into operation
within the near future.

W. Transvaal
Provincie:

Ottosdal Post Office

Lichtenburg

Plaas:

Nummer:

Distrik:

P. W. D.

Sheet No. 18. 1123 - 104

Eienaar:

Topo. Kad. Verw.

Scale = 1:2000

1718

PLAN

Municipal
office.

Dominion Reef

Shale or phyllite

Burgers
Garage

P.O.

POST OFFICE

Boreholes.

1. Dry
2. "
3. "
4. 220 gph.
5. Dry (Seepage)
6. "



S. Breda
31/8/1956

GEOLOGIESE OPNAME
GRONDWATER-OPNAMES

M.D. 20.

BESTAANDE BOORGATE

Nommer op plan	Departementale nommer	Diepte in voet	WATER				Ander gegewens b.v. oorspr. lewering en datum geboor	Aangewys deur
			Lewering in g. p. u.	Diepte gekry in voet	Rus-hoogte in voet	Soortlike weerstand, smaak, analise		

BOORGATE NIE DEUR GEOLOGIESE OPNAME
AANGEWYS NIE

1		173'	2000			(Sien versl. S.B. de Villiers	3800g.p.u. (B4)	
2		298'	3000			de Villiers	(B50)	
3		145'	2000			Lokasie boorgat	2800g.p.u.	
4		150'	1600			w.p.	(B113)	
5		?	?	?	48'	by ou slagpale		
6					52'			
7							w/v in 1955: 4'	
8								
9								
10								
11								
12								
13								
14								
15								
16								
17								
18								
19								
20								

BOORGATE AANGEWYS DEUR
GEOLOGIESE OPNAME

a							
b							
c							
d							
e							
f							
g							
h							

BOORPLEKKE AANGEWYS

Nommer op plan	G. nommer	Datum gekies	VERWYSINGS			Opmerkings	Aangewys deur
			Verslag no.	Elek. weerstand	Magn. lesings		
a	20591	2/2/66		JJ678			C. J. H. Erasmus
b	20592	3/2/66		R 881			"
c							
d							
e							
f							
g							
h							

VORIGE VERSLAE

ook verslag van mr. S.B. de Villiers gedateer 30.1.55. uit 'n verslag - Ottobal Geologiese Komitee

GEOLOGIESE OPNAME. GEOLOGICAL SURVEY.

Boorplekke.
Boring Sites.

Geofisiese Verwys. No. } 0.118
Geophysical Ref. No. }

Distrik. District.		Naam en Nommer van Plaas. Name and Number of Farm.			Eienaar. Owner.
Lichtenburg.		Ottodale Padkamp.			P.A.T.
G-nommer. G-number.	Metode van aanwysing. Method of Selection.	Formasie. Formation.	Diepte van verwerking of kontak. Depth of Weathering or Contact.	Diepte aanbeveel. Recommended Depth.	Aan wie gewys. To whom shown.
4252	geofisies	lavas	± 100vt.	105	==

OPMERKINGS EN LIGGING VAN BOORPLEKKE.
REMARKS AND POSITION OF SITES.

Boorgate in die omtrek van die voorgestelde padkamp lewer almal redelike hoeveelhede water op dieptes wat varieer van 60-100vt.

Boorplek is geleë in die verreende kam in die lavas en is geleë 39 tree vanaf die H.B.2 mylpaal (gemeet in die rigting van Lichtenburg) en ongeveer 50 tree weg van die doodsweg met bekant in klein pansette.

Boorplekke aangewys op versoek van Prov. Administrasie Verw. No. d.W. 2/639.
Sites selected at request of

Whan Wicks
Naam van Beample.
Name of Officer.

Datum 25/8/49
Date

Alphons
19/9/49

BESTAANDE BOORGATE

Kaart- nommer	Nommer	Diepte	WATER		Water -vlak	Kwaliteit S.M; smaak analiese	Verdere gegewens (oorspr. lewering)
			g.p.u. (huidige)	Diepte gekry			
1							
2							
3							
4							
5							
6							
7							
8							
9							
10							
11							
12							
13							

BOORPLEKKE AANGEWYS

Kaart- Nommer	G-Nommer	Beampte	Datum	BOORGAT RESULTAAT		
				Nommer	Diepte v. . Boorgat	Water (g.p.u.)
a	4252	wlw.	16/8/49			
b						
c						
d						
e						
f						
g						
h						
i						

VERWYSINGS

Rapporte	Geof.	Lebings	Beampte	Datum	Comerkings
G4252	O.118.		wlw.	17/10/49	

GEOLOGIESE OPNAME
GRONDWATER-OPNAMES

M.D.'20.

BESTAANDE BOORGATE

Nommer op plan	Departementale nommer	Diepte in voet	WATER				Ander gegewens b.v. oorspr. lewering en datum geboor	Aangewys deur
			Lewering in g p u	Diepte gekry in voet	Rus-hoogte in voet	Soortlike weerstand, smaak, analise		

BOORGATE NIE DEUR GEOLOGIESE OPNAME
AANGEWYS NIE

2+		111	3000		3'11"		Fontein" S.G.	
32		156	±3000		6'6"			
45		179	3880		7'		17 - "	Mr. Muller
294		±100	1300		-			
285		-	±2000		66'6"		ou lokasie "	
274		-	8000		-		S.P.S. "	
13X		±150	600		-		S.P.S. "	
25B		130	500	90	23'4"		Nuwe lokasie "	
149		-	3000		-		Stagpale "	
1570		-	sterk		-		Skoal "	
7N		184	3000		-		Pudlamp "	
1012		135	>3000	132	76		Pastorie "	Mr. Muller
13		?	800				Mr. Strauss "	
14		?	?				Mr. Louisa "	
215		?	7000				Geen pomp "	
16							Mr. Muller	
17								
18								
19								
20								

BOORGATE AANGEWYS DEUR
GEOLOGIESE OPNAME

a								
b								
c								
d								
e								
f								
g								
h								

BOORPLEKKE AANGEWYS

nmer op lan	G. nommer	Datum gekies	VERWYSINGS			Opmerkings	Aangewys deur
			Verslag no	Elek weerstand	Magn. lesings		
a	10446	16/6/55	x 32	7/36/23		2800 27/3/61	S.B. de Vries
b						Diepte > 140' 145'	
c							
d							
e							
f							
g							
h							

VORIGE VERSLAE